

For installation of Virtuo 55, refer to installation guidelines «Glue down installation of Virtuo 55». The present document explains only the specificity of herringbone laying.

## 1 - PREPARATION

To install the planks in a herringbone pattern these different axes need to be marked out.



	MEASUREMENTS OF THE DIFFERENT AXES TO BE MARKED OUT							
	Size Length Width (mm)	A1 / A2 Transversal Longitudinal Axis	B1 / B2 Diagonals	C1 / C2 // longitudinal axis	D1 / D2 Gluing area First row	E1	O- B2	Notes
Virtuo 55 glue down installation*	762 / 152.4	YES	YES	5.4 cm from axis A2	0.60 m from axis A2	7.6 cm from axis B1	Positioning of the first plank	No need to reproduce bevelled effects

\* Installation possible on SMARTFIX underlay, Guidelines [303A] :  
Mark the axes on the protective paper.  
Gently cut the protective paper as the installation progresses

Mark the axes in the following order :  
A1 / A2: Longitudinal and Transversal Axes  
B1 / B2: Diagonals  
C1 / C2: // to longitudinal axis  
D1 / D2 Gluing area of first row  
E: // to diagonal B1/B2  
O : Installation starting point

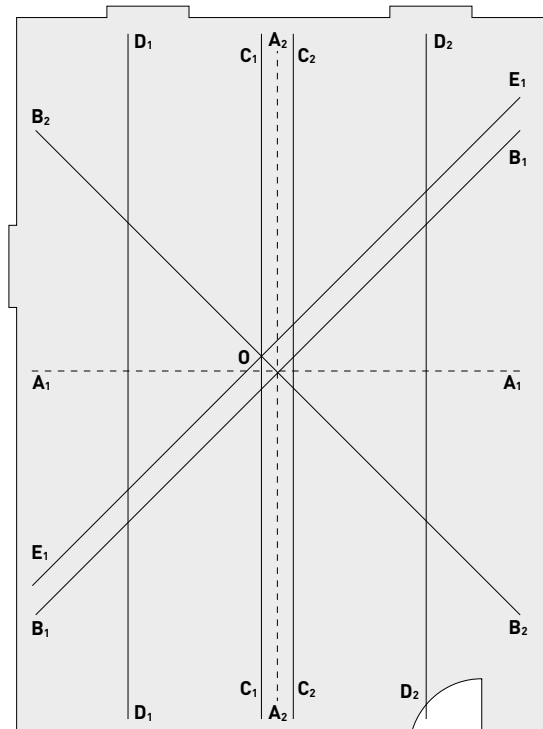

## 2 - PLANKS INSTALLATION

### 2.1 - INSTALLATION OF THE FIRST ROW

- Apply the glue on the first half row, 60 cm either side of the longitudinal axis
- Follow carefully the recommendations of the adhesive manufacturer (see technical data sheet). Depending on the nature of the subfloor, the use of a primer might be necessary.
- Position the first plank on point (O) and diagonal (E1)
- Position the second plank using the first plank and diagonal (B2) as a guide
- Carefully adjust the planks edge to edge, without any gaps between joints, in order to avoid any offset during the laying.

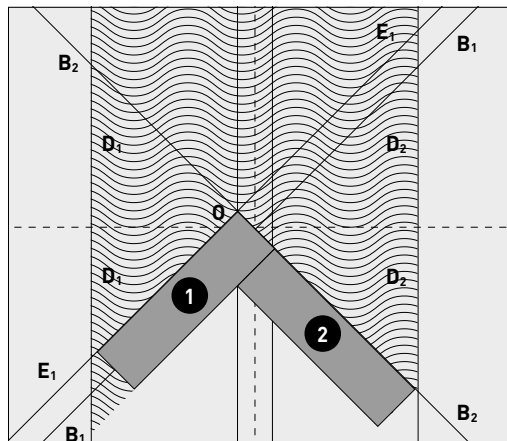
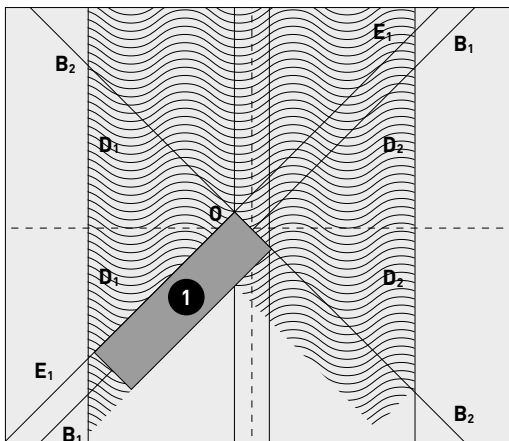

- Install the following planks on the first half glued
- Carefully adjust the planks edge to edge, without any gaps between joints, in order to avoid any offset during the laying.

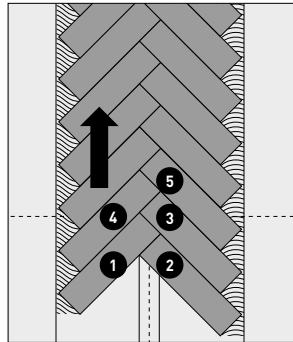

- Glue and position the 2nd half down under the cross axis

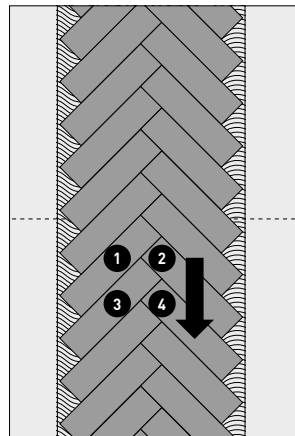

## 2.2 - INSTALLATION THE FOLLOWING ROWS

- Glue the following strips.
- Lay the third row starting from the top of the row.
- Place the first plank neatly in the corner .
- Then install all the following planks in the row .
- Continue laying the fourth row starting from the bottom of the row.
- Lay all the planks in the row.
- Proceed in the same way for all the other rows.

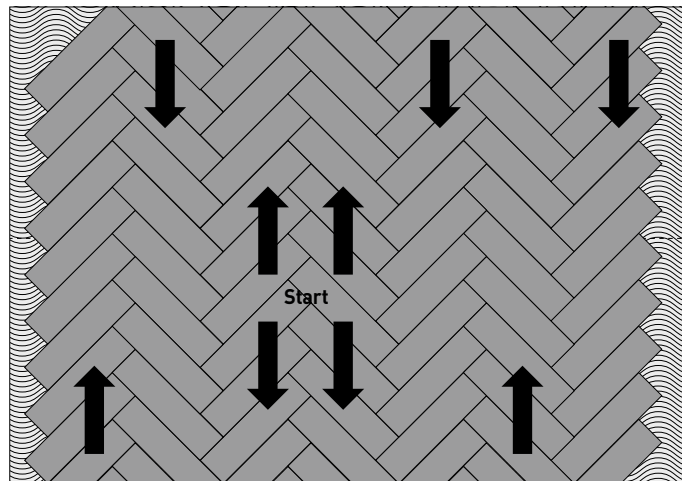
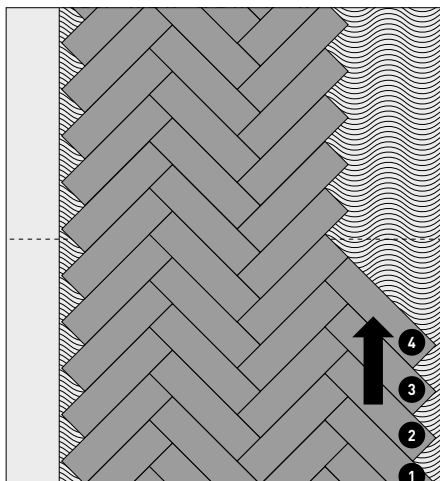
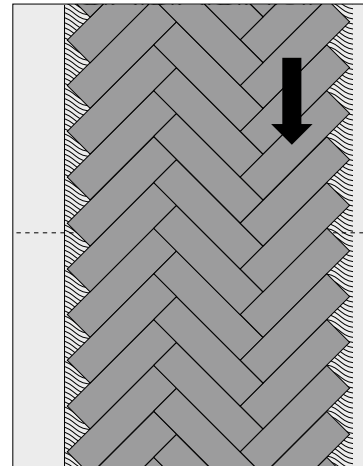
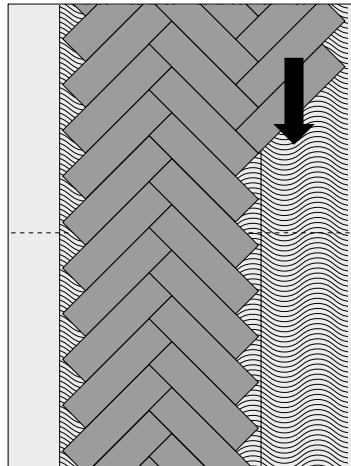

**2.3 - SMOOTHING**

Smoothing must be done in two stages:

- Manually using a smoothing press,
- Rolling with a smoothing roller over the entire surface once the installation is complete.

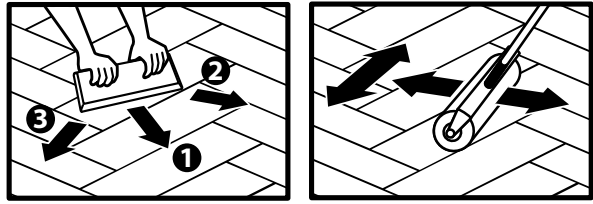
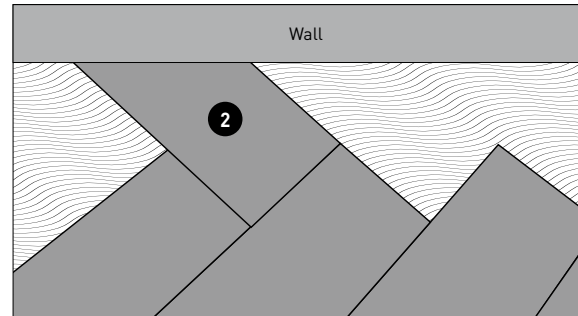
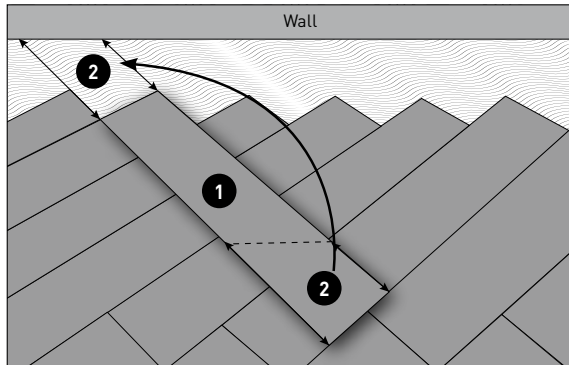
**2.4 - TRIMMING**

- 1 Put a plank on top.
- 2 Measure and mark the measurements on the planks.

This can also be done by using a pre-prepared template.